

TWO ALL-BREED  
AHBA TESTS & TRIALS



BERNESE MOUNTAIN DOG CLUB OF GREATER SEATTLE  
Sunday, April 26, 2009, 7:00 A.M. to 7:00 P.M.



BERNESE MOUNTAIN DOG CLUB OF AMERICA, INC.  
Monday, April 27, 2009, 7:00 A.M. to 7:00 P.M.

Location: Brigand's Hide Out  
9802 NE 156<sup>th</sup> St., Battle Ground, Washington 98604  
(20 Miles from Portland, OR)

Trial Secretary: Mary Dowski  
8441 W. Highway 52, Emmett, Idaho 83617  
208-365-6020, madowski@aol.com  
Pre-Entries Close 5:00 PM (MDT) April 1, 2009  
Day of Entries Accepted (see fee schedule)

**AKC DNA Profile required for all Bernese Mountain Dogs  
for Monday's Tests & Trials**

**Emergency Veterinarian: Sunday & Monday**  
Clark County Emergency Veterinary Clinic  
6818 E. Fourth Plain Blvd., Vancouver, WA 360-694-3007



BERNESE MOUNTAIN DOG CLUB OF GREATER SEATTLE  
**SUNDAY, APRIL 26, 2009**

TEST/TRIAL COMMITTEE	
TRIAL CHAIRPERSON	TRIAL SECRETARY
Bernice Lepera 9910 167th Ave NE Redmond, WA 98052 425-867-1614 skywalker5sheep@yahoo.com	Mary Dowski 8441 West HWY 52 Emmett, ID 83617 208-365-6020 madowski@aol.com

Course Director: Jim Lepera  
Additional Committee Members: Terri Zimmerman, Susan Thompson, Mona Hommel

JUDGES	
Test:	Herding Capability Test.....Ron Fischer, 25716 86 <sup>th</sup> Ave. E., Graham, WA 98338 Junior Herding Dog.....Becky Giddings, 811 117 <sup>th</sup> St. S., Tacoma, WA 98444
Trial:	Herding Trial Arena Dog.....Ron Fischer Herding Ranch Dog.....Becky Giddings

CLASSES OFFERED: SHEEP ONLY (Dorper cross & wool cross)
Herding Capability Test, Junior Herding Dog, Herding Ranch Dog Course I, II & III, Herding Trial Arena Dog Course I, II and III
<b>Limited to 60 runs or fewer (depending upon livestock numbers) per combined Test &amp; Trial</b>

ENTRY FEES
<b>\$45.00 per Pre-entry (Received by 5:00pm MDT 4/1/09)</b> <b>\$50.00 per Day of Entry (Considered any entry received after 5:00pm MDT 4/1/09)</b>
1. Pre-entries cancelled after the closing date or day of entries received prior to the date of trial will not be refunded if cancelled.
2. Entry fees include the \$2.50 AHBA recording fee imposed for a qualifying run
3. <b>Waive signature</b> on Express Delivery Items or else date of entry received will be the date the item is retrieved from US Post Office

LIMITED ENTRY SELECTION
Pre-entries are recorded in order received. Bernese Mountain Dog entries are given preference to all other breeds. If limit is reached on 4/1/09, those runs not occupied by Bernese Mountain Dogs, will be determined by 1) date of entry received and 2) "blind draw" by the event secretary including those entries that were received on the same day. (Blind draw means that if there are multiple entries received on the same date that may be eligible for the remaining open runs; those entries will be placed in a box and drawn as to the remaining number of open runs available without knowledge of exhibitor, breed or class.) Entrants will be notified by email as to entry status by 4/8/09. If no email address is provided, entrants will be contacted via telephone or US Postal service.

AWARDS (Sunday, April 26, 2009)
<b>A ring favor will be given to each entrant.</b> donated by Jeannie Hanhi and Steve Noel <b>Qualifying rosette will be given to each dog earning a qualifying run and Rosette for 1<sup>st</sup> - 4<sup>th</sup> place in trial classes.</b> donated by Anne Artin <b>High in Trial. Filled Treat Basket, Note cards and Rosette-</b> donated by Pudge Delaney <b>High Trial Bernese Mountain Dog. Framed Sheep Tile and Rosette-</b> donated by Susan Parr <b>Oldest Qualifying BMD. Mug &amp; Note Cards-</b> donated by Lisa Kaufman <b>Youngest Qualifying BMD. Mug-</b> donated by Judy Eskridge



BERNESE MOUNTAIN DOG CLUB OF AMERICA, INC.  
**MONDAY, APRIL 27, 2009**

**TEST/TRIAL COMMITTEE**

TRIAL CHAIRPERSON	TRIAL SECRETARY
Bernice Lepera 9910 167th Ave NE Redmond, WA 98052 425-867-1614 skywalker5sheep@yahoo.com	Mary Dowski 8441 West HWY 52 Emmett, ID 83617 208-365-6020 madowski@aol.com

Course Director: Jim Lepera

Additional Committee Members: April Rifenburg, Lisa Kaufman, Nancy Melone

**JUDGES**

Test:	Herding Capability Test.....Becky Giddings, 811 117 <sup>th</sup> St. S., Tacoma, WA 98444
	Junior Herding Dog..... Ron Fischer, 25716 86 <sup>th</sup> Ave. E., Graham, WA 98338
Trial:	Herding Trial Arena Dog.....Becky Giddings
	Herding Ranch Dog..... Ron Fischer

**CLASSES OFFERED: SHEEP ONLY (Dorper cross & wool cross)**

Herding Capability Test, Junior Herding Dog,  
 Herding Ranch Dog Course I, II & III,  
 Herding Trial Arena Dog Course I, II and III

**Limited to 60 runs or fewer (depending upon livestock numbers) per combined Test & Trial**

**ENTRY FEES**

**\$45.00 per Pre-entry (Received by 5:00pm MDT 4/1/09)**

**\$50.00 per Day of Entry (Considered any entry received after 5:00pm MDT 4/1/09)**

1. Pre-entries cancelled after the closing date or day of entries received prior to the date of trial will not be refunded if cancelled.
2. Entry fees include the \$2.50 AHBA recording fee imposed for a qualifying run
3. **Waive signature** on Express Delivery Items or else date of entry received will be the date the item is retrieved from US Post Office

**LIMITED ENTRY SELECTION**

Pre-entries are recorded in order received. Bernese Mountain Dog entries are given preference to all other breeds. If limit is reached on 4/1/09, those runs not occupied by Bernese Mountain Dogs, will be determined by 1) date of entry received and 2) "blind draw" by the event secretary including those entries that were received on the same day. (Blind draw means that if there are multiple entries received on the same date that may be eligible for the remaining open runs; those entries will be placed in a box and drawn as to the remaining number of open runs available without knowledge of exhibitor, breed or class.) Entrants will be notified by email as to entry status by 4/8/09. If no email address is provided, entrants will be contacted via telephone or US Postal service.

**AWARDS (Monday, April 27, 2009)**

**A ring favor will be given to each entrant** donated by Barb McColgan Pastore in memory of Windraider's Ruthless Ruthie, CD, RN, CGC, HCT-s

**Qualifying rosette will be given to each dog earning a qualifying run and Rosette for 1<sup>st</sup> - 4<sup>th</sup> place in trial classes** donated by Mie Kingsley in loving memory of Petra, Maine's Yodelin' Bear CDX, RE and Adam & Amy Conn, Purple BMD's,

**High in Trial. Filled Treat Basket, Sheep Wall Hook and Rosette-** donated by April & Erv Rifenburg and Bernice & Jim Lepera

**AWARDS (Monday, April 27, 2009) Continued**

**High Trial Bernese Mountain Dog. Framed Sheep Tile and Rosette-** donated by Nancy Melone and Todd & Jennifer Zaayer in loving memory of Ch. Wagontale's Dashing Thru Snow DD, BNDD, CGC, TT  
**Oldest Qualifying BMD. Mug & Note Cards-** donated by Kathy & Jim Gray in loving memory of Ch. Telstar's Holiday Magic NA, NAP, CGC, TT, NDD a BMDCA Versatility Dog  
**Youngest Qualifying BMD. Mug-** donated by Toby Erlichman & Claire Coppola in loving memory of "Hans", Ch. Erlo vom Obwaldnerhof CD, NDD, HCT-s, CGC, TDI (1996-2005)  
**AKC champion of record Bernese Mountain Dog completing a title. Bernese Mountain Dog Item-** donated by Mary Dowski, Car-Rae Kennels, LLC in loving memory of Am/Can Ch. Car-Rae's High Hopes O' Bernhugel, CD, HIC

**HERDING TRIAL ARENA DOG - COURSE #4 DESCRIPTION  
 (Gather & Ribbon Pull Sort)**

**COURSE #4**

**1. Gather**

Gather: The stock are set out in the arena. The dog is sent to gather the animals and bring them to the post. The stock are moved counter-clockwise around the post.

HTAD III – the handler remains at the post while the dog gathers the stock.

HTAD II – the dog remains at the post; the handler may go halfway to the stock before sending the dog.

HTAD I – the dog may be taken halfway to the set-out point; the handler may approach to within 15 ft. of the stock.

**2. Drive**

The stock are driven to Obstacle 1. HTAD III handlers must stay at handler's post. HTAD II handlers may go half the distance to Obstacle 1, then remain at that distance for the remainder of the drive. HTAD I handlers may accompany the stock. The drive ends when the stock reach a point 10 ft. in front of Obstacle 1.

**3. Obstacle 1**

The handlers remain at the designated locations while the stock are taken through the obstacle. Once the stock have cleared the obstacle, the handler may move from the handler's post. Just past Obstacle 1, the stock are turned toward the west side of the arena, then back toward the north side, toward Obstacle 2. Scoring for this section ends when the stock have moved past the end of Obstacle 1 closest to the west side of the arena.

**4. Obstacle 2**

The stock should enter at the south opening of the obstacle and exit heading east. HTD I handlers may move anywhere relative to the obstacle but may not enter it. HTD II handlers may move along the first section of the panel but may not move past the corner until the stock have exited. HTD III handlers may not pass the opening of the obstacle until the stock have exited. Scoring ends when the animals have exited.

**5. Obstacle 3**

The stock are taken across the arena and put into the free-standing pen. Scoring for the pen ends when the gate is closed.

**6. Sort**

The animals are removed from the pen and taken to the sorting area. HTAD I and II handlers briefly hold the stock, then take them to the repen. For HTAD III handlers, the sort may be one of the following: (a) Gate sort. (b) Ribbon-removal/shed. The sort ends for HTAD I and II at the conclusion of the hold, and for HTAD III when the gate is closed on the sorted animals, or when the ribbon has been removed/animals have been shed.

**7. Reopen**

The stock are taken to the repen and held a short distance off the gate while it is opened, and then they are repenned. When a gate-sort has been used, the animals that had been left out in the arena are repenned. The run ends when the repen gate is closed.

**HRD COURSE DIAGRAM**

Gather 10 sheep from Pen 1, 5 are marked

Take sheep across driveway—not losing them

Sort 5 unmarked sheep into pen 2

Take 5 unmarked sheep  
Back to pen 1

Take 5 sheep through pen 2 into pen 3

In pen 3  
Level 1...fetch sheep through panel to set out—  
leave sheep to go to post and do outrun lift fetch  
and fetch course

Level 2...fetch sheep to post—drive to set out—  
leave sheep go to post, outrun lift fetch and fetch  
to first panel, drive to second panel, (handler can  
move to fetch panel 1/2 way)

Level 3...fetch sheep to post, drive to set out,  
leave sheep go to post, outrun lift fetch and drive  
course (panel 1 and 2)

After panels...  
Level 1...take 5 sheep to gate "B" and exhaust  
Level 2...take 3 any 3 sheep to gate "A", exhaust 3  
sheep, take last 2 sheep to gate "B", exhaust  
Level 3...take 5 sheep to gate "A", exhaust  
4sheep, talk last 1 to gate "B" and exhaust  
Handlers go through gate "B" with dog walk to gate  
"C", not disturbing sheep, then exit gate "D"

Drawing NOT to scale

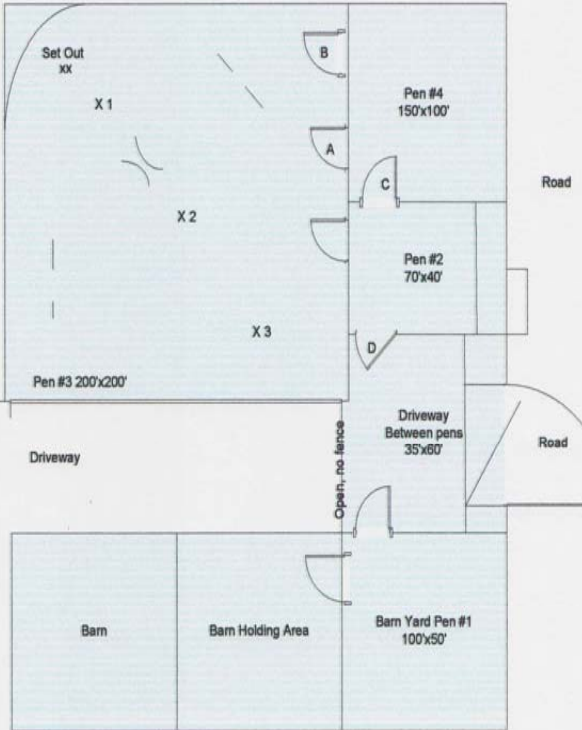

Gates may swing either way

BRIGAND'S HIDEOUT  
BATTLE GROUND, WA

April 26, 2009-April 27,  
2009

AHBA TEST/TRIAL  
HRD I, II, III

**HOTELS**

**Please contact the individual hotel regarding their pet policy.**

Red Lion Hotel on the River..... 909 N. Hayden Island Dr., Portland, OR (503) 978-4598  
Shilo Inn- Salmon Creek..... 13206 Hwy 99, Vancouver, WA 98686 (360) 573-0511

**RV PARKING & CAMPSITES**

Battle Ground Lake State Park, for reservations.....888-CAMPOUT

**DIRECTIONS TO TRIAL SITE**

Take I-5 North or South, (Or Hwy 205 North to merge with I-5), Exit #9 Battleground (179th Ave)  
Go east toward Battleground on 179th St., Past 72nd Ave (signal light), right on 92nd Ave (about a mile further), 92nd Ave curves to left and becomes 156th St. Turn left at 9628 NE 156th St (just before the row of trees on the left)

**LUNCH**

Will be available for purchase at show site. \$7.00 per lunch; breakfast- donation  
Sunday Lunch: Spaghetti (no meat), salad, bread, drink  
Monday Lunch: No Meat Chili, salad, bread, drink  
Breakfast both days: coffee, juice, fruit



**LUNCH RESERVATION**

Sunday: Spaghetti (no meat), salad, bread, drink \_\_\_\_\_ x \$7.00 = \_\_\_\_\_

Monday: No Meat Chili, salad, bread, drink \_\_\_\_\_ x \$7.00 = \_\_\_\_\_

Name: \_\_\_\_\_

Sunday Lunch- make checks payable to BMDCGS

Monday Lunch- make checks payable to BMDCA2009

Return with entries to Mary Dowski, 8441 W. Highway 52, Emmett, ID 83617

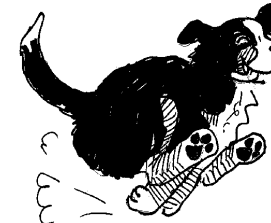

All-Breed Test/Trial AHBA Entry Form

Sunday-Monday, April 26-27, 2009

Brigand's Hide Out 9802 NE 156<sup>th</sup> St., Battle Ground, Washington 98604

Pre-Entries Close April 1, 2009 at 5:00 pm MDT at which time pre-entries cannot be cancelled. Pre-entry preference is given to Bernese Mountain Dogs. All-breed pre-entries are accepted in order of date received. If limit is reached, all entries received on date of reaching limit will be selected by a "blind draw". Please see premium list for details. Day of Entry is considered any entry received after 5:00pm MDT 4/1/09 to day of test/trial.

(Entries limited to 60 runs or fewer per combined test/trial)

Mail entries to Mary Dowski, 8441 W. Highway 52, Emmett, Idaho 83617

Make checks payable to: SUNDAY ENTRIES: BMDCGS Total Fees Enclosed: \$ \_\_\_\_\_

MONDAY ENTRIES: BMDCA2009 Total Fees Enclosed: \$ \_\_\_\_\_

\$45.00 per Pre- entry per class; \$50.00 Day of Entry per class; Includes \$2.50 per qualifying run recording fee

Entry Class: (Circle) Sunday: HCT JHD HTAD I HTAD II HTAD III HRD I HRD II HRD III

Entry Class: (Circle) Monday: HCT JHD HTAD I HTAD II HTAD III HRD I HRD II HRD III

Dog's Registered Name: \_\_\_\_\_

Breed: \_\_\_\_\_ DOB: \_\_\_\_\_ DNA# (BMD's Only): \_\_\_\_\_

Registry Name & No. \_\_\_\_\_ Sex: M / F

Sire: \_\_\_\_\_

Dam: \_\_\_\_\_

Breeder: \_\_\_\_\_

Owner: \_\_\_\_\_

Address: \_\_\_\_\_

Telephone: \_\_\_\_\_ Email: \_\_\_\_\_

Handler: \_\_\_\_\_

In consideration for participation in an event sanctioned by the American Herding Breed Association (AHBA), I agree to assume all responsibility for any claim, loss or damage, of whatever kind or nature, whether to person or property, which may be caused at or near this event, either directly or indirectly, by me or the dog or dogs I have entered in or brought to this event. I further agree that I will hold the AHBA, the BMDCGS (Sunday), the BMDCA (Monday) and Brigand's Hide Out, and their officers, directors, agents and members or owners harmless and defend them from any and all liability for any injury, claim, damage or loss, of whatever kind or nature, whether to person or property, caused at or near this event, whether directly or indirectly, by me or any dog I have entered in or brought to this event. I agree to indemnify the AHBA, the BMDCGS (Sunday), the BMDCA (Monday) and Brigand's Hide Out, and their officers, directors, agents and members or owners for any loss, cost or expense including attorneys fees and costs, to which the AHBA, the BMDCGS (Sunday), the BMDCA (Monday) and Brigand's Hide Out, and their officers, directors, agents or members or owners might be subject as a result of any claim, suit, loss or damage caused in any way by any act or negligence on my part or on the part of any dog or dogs I have entered in or brought to this event. I acknowledge that while the AHBA may provide sanctioning for this event with regard to the issuing of titles, it does not have and does not exercise control over the conduct of the event or those present. I certify and represent that the dog or dogs I have entered in or brought to this event is/are not a hazard to other dogs, other animals, or to people.

The cost of the animal will be charged to the owner of any dog causing damage to livestock used in trial or on property. Sheep are valued at \$200.00 each. Damage to property at cost, other livestock on property: geese and chickens \$35, alpacas \$15,000.00, cattle \$2500.00, guardian dogs \$2000.00. Damage to neighboring properties assessed at cost to replace damage. Anyone driving on grass \$50.00. By signing this entry, I agree that I have read and understand the statements above.

Owner's Signature: \_\_\_\_\_

All-Breed Test/Trial AHBA Entry Form

Sunday-Monday, April 26-27, 2009

Brigand's Hide Out 9802 NE 156<sup>th</sup> St., Battle Ground, Washington 98604

Pre-Entries Close April 1, 2009 at 5:00 pm MDT at which time pre-entries cannot be cancelled. Pre-entry preference is given to Bernese Mountain Dogs. All-breed pre-entries are accepted in order of date received. If limit is reached, all entries received on date of reaching limit will be selected by a "blind draw". Please see premium list for details. Day of Entry is considered any entry received after 5:00pm MDT 4/1/09 to day of test/trial.

(Entries limited to 60 runs or fewer per combined test/trial)

Mail entries to Mary Dowski, 8441 W. Highway 52, Emmett, Idaho 83617

Make checks payable to: SUNDAY ENTRIES: BMDCGS Total Fees Enclosed: \$ \_\_\_\_\_

MONDAY ENTRIES: BMDCA2009 Total Fees Enclosed: \$ \_\_\_\_\_

\$45.00 per Pre- entry per class; \$50.00 Day of Entry per class; Includes \$2.50 per qualifying run recording fee

Entry Class: (Circle) Sunday: HCT JHD HTAD I HTAD II HTAD III HRD I HRD II HRD III

Entry Class: (Circle) Monday: HCT JHD HTAD I HTAD II HTAD III HRD I HRD II HRD III

Dog's Registered Name: \_\_\_\_\_

Breed: \_\_\_\_\_ DOB: \_\_\_\_\_ DNA# (BMD's Only): \_\_\_\_\_

Registry Name & No. \_\_\_\_\_ Sex: M / F

Sire: \_\_\_\_\_

Dam: \_\_\_\_\_

Breeder: \_\_\_\_\_

Owner: \_\_\_\_\_

Address: \_\_\_\_\_

Telephone: \_\_\_\_\_ Email: \_\_\_\_\_

Handler: \_\_\_\_\_

In consideration for participation in an event sanctioned by the American Herding Breed Association (AHBA), I agree to assume all responsibility for any claim, loss or damage, of whatever kind or nature, whether to person or property, which may be caused at or near this event, either directly or indirectly, by me or the dog or dogs I have entered in or brought to this event. I further agree that I will hold the AHBA, the BMDCGS (Sunday), the BMDCA (Monday) and Brigand's Hide Out, and their officers, directors, agents and members or owners harmless and defend them from any and all liability for any injury, claim, damage or loss, of whatever kind or nature, whether to person or property, caused at or near this event, whether directly or indirectly, by me or any dog I have entered in or brought to this event. I agree to indemnify the AHBA, the BMDCGS (Sunday), the BMDCA (Monday) and Brigand's Hide Out, and their officers, directors, agents and members or owners for any loss, cost or expense including attorneys fees and costs, to which the AHBA, the BMDCGS (Sunday), the BMDCA (Monday) and Brigand's Hide Out, and their officers, directors, agents or members or owners might be subject as a result of any claim, suit, loss or damage caused in any way by any act or negligence on my part or on the part of any dog or dogs I have entered in or brought to this event. I acknowledge that while the AHBA may provide sanctioning for this event with regard to the issuing of titles, it does not have and does not exercise control over the conduct of the event or those present. I certify and represent that the dog or dogs I have entered in or brought to this event is/are not a hazard to other dogs, other animals, or to people.

The cost of the animal will be charged to the owner of any dog causing damage to livestock used in trial or on property. Sheep are valued at \$200.00 each. Damage to property at cost, other livestock on property: geese and chickens \$35, alpacas \$15,000.00, cattle \$2500.00, guardian dogs \$2000.00. Damage to neighboring properties assessed at cost to replace damage. Anyone driving on grass \$50.00. By signing this entry, I agree that I have read and understand the statements above.

Owner's Signature: \_\_\_\_\_